



Scenic Pacifica
Incorporated Nov. 22, 1957

CITY OF PACIFICA
Planning, Building, and Code Enforcement
1800 Francisco Blvd. • Pacifica, California 94044-2506
(650) 738-7341 • www.cityofpacifica.org

MAYOR
Sue Digre

MAYOR PRO TEM
Mike O'Neill

COUNCIL
Karen Ervin
Mary Ann Nihart
John Keener

April 21, 2016

Steve Svienty
867 47th Ave., Apt. #A
San Francisco, CA 94121

Subj: Heritage Tree Removal Permit – 1060 Terra Nova Blvd.

Dear Mr. Svienty:

The City of Pacifica is in receipt of your request to remove 19 trees at the address listed above as regulated under the City's Preservation of Heritage Trees ordinance. The City Arborist has reviewed your application and arborist report and is in agreement that the trees should be removed. Specifically, the existing trees are unsustainable and are too large for the area in which they are planted. The trees are in close proximity to the adjacent apartment building and they are located under a powerline. The trees have been severely topped to avoid the powerlines. Severe topping can lead to decay and may present a hazard as the multiple leaders that grow from wound sites are generally weakly attached to the tree.

In accordance with the provisions of Pacifica Municipal Code Title 4, Article 12, the City is proposing to approve your request subject to the following conditions:

1. The 19 trees permitted to be removed shall be those discussed and shown in the Arborist Report prepared by Mr. Donald Cox, dated April 19, 2015.
2. The property owner shall give notice to tenants at least three days prior to actual removal.
3. An encroachment permit shall be obtained from the Department of Public Works for any necessary street or lane closure on Terra Nova or use of the street for removal equipment/vehicles. All conditions of the encroachment permit shall be implemented, including complete debris removal from the public right-of-way.
4. Replacement trees shall be installed within one month of the start of tree removal as shown on the landscape plan submitted by the owner/applicant prepared by HWA Landscape Architects (attached). This will allow the owner/applicant time to prep the site with necessary irrigation and companion plantings (see condition 5).

5. The areas depicted with diagonal hash marks on the HWA landscape plan shall be planted with live shrubs and ground cover that is drought tolerant and appropriate for the local climate. Irrigation shall be provided until plants are established and only as needed thereafter.

Notice of this proposed decision will be posted and mailed as required by the Municipal Code. This proposed decision may be appealed to the Parks, Beaches, and Recreation Commission within seven days of the notice.

Sincerely,

A handwritten signature in black ink that reads "Tina Wehrmeister". The signature is written in a cursive, flowing style.

Tina Wehrmeister
Planning Director

cc: Department of Public Works

Planting Legend

QUANT.	SIZE	BOTANICAL NAME	COMMON NAME	COMMENTS
TREES:				
8	24" Box	<i>Craetagus phaenopyrum</i>	WASHINGTON THORN	PG&E Approved Tree

Planting Notes

- Quantities of plant materials shall be furnished to complete the work as shown by symbols on the planting plan. Plant legend quantities are for the contractor's convenience only. Should it appear that the work to be done is not sufficiently detailed or explained on these plans, the contractor shall contact the landscape architect for further clarification as may be necessary.
- Contractor to install root barriers per detail on this sheet.

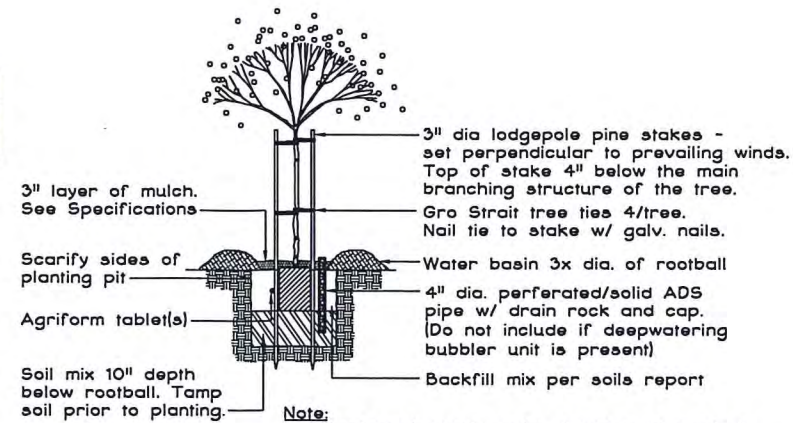

- Note:**
- Planting pit shall be 2x diameter of rootball
 - Use 21 gram Agriform tablets as follows:
 - One (1) per 1-gal container
 - Three (3) per 5-gal container
 - Five (5) per 15-gal container

1 Tree Planting

n.t.s.

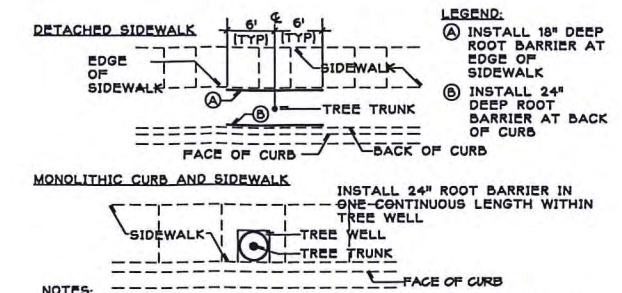

- LEGEND:**
- (A) INSTALL 18" DEEP ROOT BARRIER AT EDGE OF SIDEWALK
 - (B) INSTALL 24" DEEP ROOT BARRIER AT BACK OF CURB
- NOTES:**
- 18" ROOT BARRIER AND 24" ROOT BARRIER SHALL BE HIGH DENSITY AND HIGH IMPACT PLASTIC AS AVAILABLE FROM "DEEP ROOT", 345 LORTON AVE., SUITE 103, BURLINGTON, CA 94010 AT 1-800-458-7668, OR FROM "ROOT SOLUTIONS", INC., 3276 KITCHEN DRIVE, CARSON CITY, NEVADA 89701, AT 1-702-788-9577.
 - TOP OF ROOT BARRIER SHALL BE SET 1/2-INCH ABOVE FINISHED GRADE OF SOIL, BUT UNDER NO CIRCUMSTANCES SHALL THE TOP OF ROOT BARRIER EXTEND ABOVE ADJACENT CURB, SIDEWALK OR OTHER HARD SURFACING, AND SHALL BE INSTALLED IN ACCORDANCE WITH MANUFACTURER'S INSTRUCTIONS.

2 Deep Root Barrier

n.t.s.

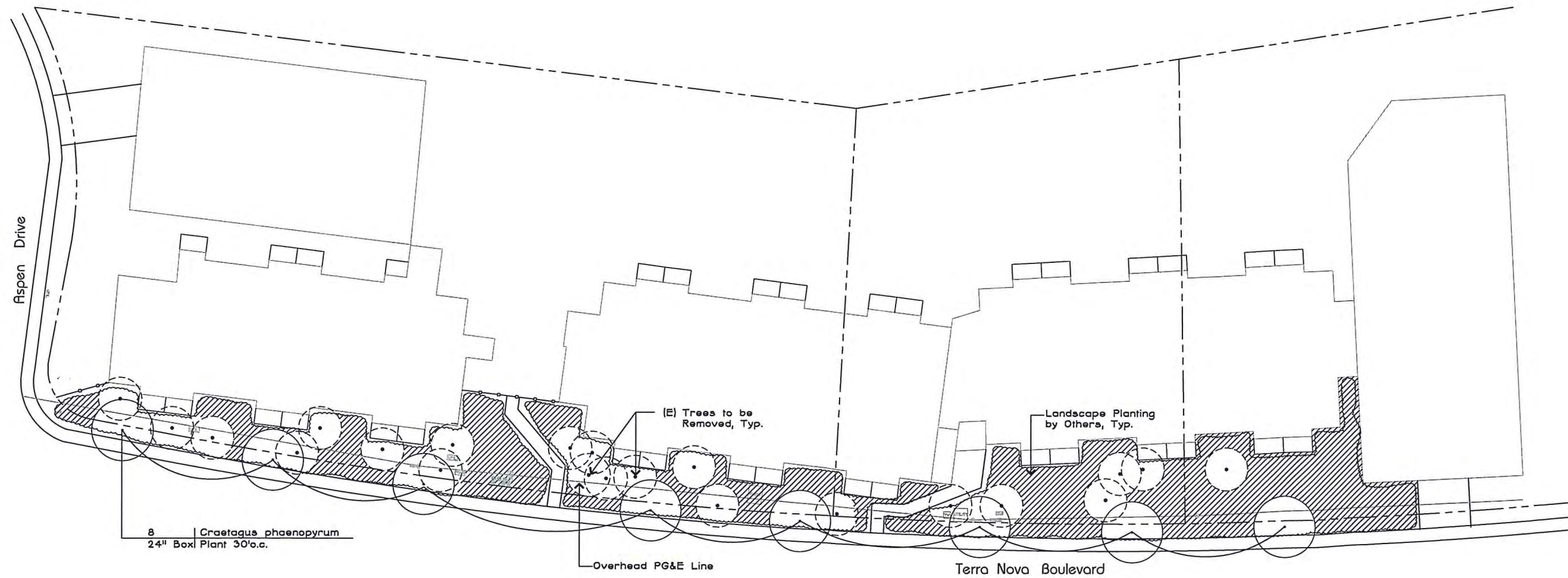

8 | *Craetagus phaenopyrum*
24" Box | Plant 30'o.c.

Overhead PG&E Line

Terra Nova Boulevard

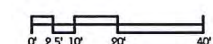

Casa Pacifica Apartments
1060 Terra Nova Boulevard
Pacific, California

Street Tree Plan

date: 0
scale: 1"=80'
revisions:

sheet:

L.1

of 1 sheets



Scenic Pacifica
Incorporated Nov. 22, 1957

CITY OF PACIFICA

170 Santa Maria Avenue • Pacifica, California 94044-2506
www.cityofpacifica.org

MAYOR
Sue Digre

MAYOR PRO TEM
Mike O'Neill

COUNCIL
Karen Ervin
Mary Ann Nihart
John Keener

NOTICE OF TREE REMOVAL APPLICATION APPEAL

The City of Pacifica has received several written appeals to the proposed tree removals at 1060 Terra Nova Blvd. The matter has therefore been referred to the Parks, Beaches and Recreation Commission. The matter will be heard and a decision will be made at the regular monthly meeting of the commission. All of the concerned parties will be allowed to present their opinions on the matter at this time. This meeting is scheduled for:

**Wednesday, June 22, 2016 at 7:00 p.m. at the
City Council Chambers, 2212 Beach Blvd.**

Agenda materials are available to review online
at www.cityofpacifica.org/depts/rec_department/pbrcommission/

If you have any questions regarding this matter, please contact the Parks, Beaches and Recreation Department at 650-738-7381 or the Planning Department at 650-738-7341.

RECEIVED

MAY 18 2016

City of Pacifica

WED MAY 18

Tuesday May 17, 2016

Ms. Tina Wehrmeister
City Planner
City of Pacifica
1800 Francisco Blvd.
Pacifica, CA 94044.

Ms Wehmeister:

Steve Svenity, the tree service guy who filed the permit to cut down our trees last year and this, says on his website that he's been a certified member of **ISA** since 1989. See attached.

I did a google search for "**ISA**". It most surely is the International Society of Arboculture. See attached I checked to see if Steve Svenity is truly a member or not.

ISA report came back fast. See below. He's never been a member or a "certified member" who's earned the right to hang his certification placard on his office wall.

I should think that might give you pause in accepting any of his advice as professionally valid.

Note, on his application for a permit to cut down the trees filed last year, he described the trees as "mutilated and destroyed."

That description of the trees is grossly exaggerated and mischaracterized. Do these trees look mutilated and sickly to you?

Otherwise, we are still waiting for your reply to the many questions asked in my letter of April 28 delivered to City Hall in person and to my latest reminder mailed May 12.

Thank you

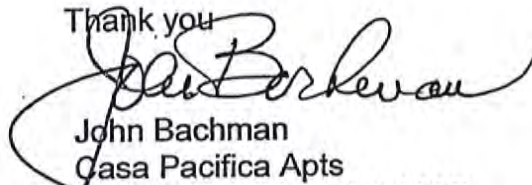
John Bachman
Casa Pacifica Apts
1060 Terra Nova Blvd 209B
Pacifica, CA 94044
650-557-1507 tele and fax
JhnBachman@aol.com .

From: isa@isa-arbor.com
To: JhnBachman@aol.com
Sent: 5/13/2016 11:07:49 A.M. Pacific Daylight Time
Subj: RE: Verification of an arborhist's membership & certification

Thank you for contacting ISA.

I found two listings in our database when searching for Steve or Stephen Svienty, each listing corresponds with one of the addresses you mentioned in your email. Neither of these listings show that Steve or Stephen Svienty is an ISA member OR a Certified Arborist.

ISA does not require proof of insurance in order to take the ISA Certified Arborist Exam or to maintain a credential.

Please contact ISA if you need further assistance.

Allyson Rotramel
ISA Customer Relations Senior Coordinator
Toll Free: 888-472-8733
Fax: 217-355-9516
P. O. Box 3129
Champaign, IL 61826

ATTENTION

This E-mail may contain PRIVILEGED AND CONFIDENTIAL INFORMATION intended only for the use of the Individual(s) named above. If you are not the intended recipient of this E-mail, or the employee or agent responsible for delivering it to the intended recipient, you are hereby notified that any dissemination or copying this E-mail is strictly prohibited. If you have received this E-mail in error, please immediately notify us by telephone at (217) 355-9411 or notify me by e-mail at arotramel@isa-arbor.com.

-----Original Message-----

From: JhnBachman@aol.com [mailto:JhnBachman@aol.com]
Sent: Friday, May 13, 2016 12:05 PM
To: ISA Customer Service <isa@isa-arbor.com>
Subject: Verification of an arborhist's membership & certification

Friday May 13, 2016

Good Morning ISA

We have been approached by an arborhist from San Francisco to remove about 20 large trees in front our two apartment buildings.

Would you be so kind as to verify the membership and certification status of one Steve Svienty, whose firm goes by the name of Svienty Tree Services?.

He has two addresses in this locale:

1. Steve Svienty
867 47th Ave., Apt A, SF CA 94121
2. Steve Svienty or Svienty Tree Service
211 Cardinal Road, Mill Valley CA 94941

His website says he has been a certified member of ISA since 1989.

I just ran the same inquiry using the VERIFY A CERTIFICATION form on your website and entering his name only. Steve Svienty.

I got this reply: NO RESULT

Your confirmation would be most appreciated.

Last question please: Does the Society require that arborists submit proof of operating insurance as a part of your certification process?

Many thanks

John Bachman
Casa Pacifica Apts
1060 Terra Nova Blvd 209B
Pacifica, CA 94044
650-557-1507 tele and fax
JhnBachman@aol.com <mailto:JhnBachman@aol.com>

[Home](#)[LOGIN or CREATE AN ACCOUNT](#)[Home](#) > [Find an Arborist](#) > [Arborist Search](#) > [Verify an ISA Credential](#)[Verify an ISA Credential](#)

Best Management Practices - Tree Planting, Spanish Edition

ISA Members: \$9.95

Non-Members: \$11.95

Price in US Dollars

[Add to Cart](#)

Verify an ISA Credential

This tool allows you to verify if an individual currently holds an ISA credential. It includes all individuals who are currently credentialed through the [ISA credentialing program](#). Not all individuals listed are available for hire. To find an arborist to provide tree care services, use the [Find an Arborist](#) tool.

If you are having difficulty verifying an arborist's credentials, you may contact ISA at isa@isa-arbor.com or +1.217.355.9411.

Search by Name

OR

Search by Certification Number

[Search](#)

[Search](#)

©International Society of Arboriculture 2009-2016

PO Box 3129 • Champaign, IL 61826, USA • +1.217.355.9411

[Email comments and questions to ISA](#)

Friday, May 13, 2016 10:38:00 AM (CST/ISA Headquarters Time)

Please click here to view our [privacy policy](#).

[About ISA](#) • [Find an Arborist](#) • [Newsroom](#) • [Job Bank](#) • [Contact Us](#) • [LOGIN](#)[Home](#)[LOGIN or CREATE AN ACCOUNT](#)[Home](#) > [Find an Arborist](#) > [Arborist Search](#) > [Verify an ISA Credential](#)[Verify an ISA Credential](#)

Tree Climbers' Guide, 3rd Edition

ISA Members: \$54.95

Non-Members: \$64.95

Price in US Dollars

[Add to Cart](#)

CREDENTIAL VERIFICATION

Name search 'Steve Svienty' returned 0 records

[Back to Search](#)

No results.

[Explanation of ISA certification credentials](#)

[Explanation of ISA qualifications](#)

John, go to johnbachman335@gmail.com to complete the sign-up process.

[Confirm Now](#)

[Resend Email](#) · [Enter Code](#) · [Change Email Address](#)



[Timeline](#)

About

[Photos](#)

[Reviews](#)

[More ▾](#)

[Like](#)

[Message](#)

About Steve Svienty Tree Care

Overview

[Page Info](#)



211 Cardinal Rd
Mill Valley, CA

[Save](#)

(415) 328-4894

Open
Today 7:30AM - 4:00PM

Price Range: \$

<http://www.s-svienty-tree-c...>

FALSE



Insured, ISA Arborist, Since 89, We specialize in tree removal, tree trimming(all phases), brush clearing(all phases),stump removal, yard/garden cleanups

[Chat](#)



Existing View of Trees to be removed along Street Front at

1060 Terra Nova Blvd, Pacifica CA 94044

Thursday May 12, 2016

Ms Tina Wehrmeister
Planning Director
City of Pacifica
1800 Francisco Blvd.
Pacifica, CA 94044

Dear Ms Wehrmeister

RECEIVED
MAY 17 2016
City of Pacifica

RE: City's proposal to approve the pending permit for demolition of the Heritage Trees

On behalf of all the residents of the Casa Pacifica Apartments, we would much appreciate your reply to the several questions raised in my 3 page letter of objection about the above which was filed with City Hall on April 28th at 3 PM.

The first notice for demolition of the trees came from the City **last year** with yellow notices posted on the trees themselves. Many of us delivered written objections at that time and we were subsequently advised of a hearing date. But each date that was set was subsequently canceled 3 or more times. After the last cancellation we heard no further word from the City and assumed that the matter was settled and the trees would not be demolished.

The second notice for demolition of the trees came **this year** with yellow notices on the trees followed by the letter you sent to myself, Betty Garner and Sharon Emerson Smith (all residents here) But we have not received any notice about any hearings as before.

Please advise if there is a formal appeal process to follow or if there are any other formal steps we must take to register our objections.

We presumed that the delivery this year of written objections to City Hall would establish our formal appeal as it did last year, but your letter this year included no instructions to that effect.

Sincerely



John Bachman
Casa Pacifica Apts.
1060 Terra Nova Blvd 209B
Pacifica, CA 94044
650-557-1507 tele and fax
JhnBachman@aol.com

PS

Jane Northrop's Tribune story about the trees headlined yesterday that the City had

already OK'd the cutting of thr trees. I corrected her yesterday reminding her that your letter to Sventy (copy to us) only indicates that the City was *proposing to approve*, not that it had actually gone ahead without hearings and done so. Your correction of the status of the matter to Jane would be much appreciated. Thank you.

RECEIVED
MAY 03 2016
City of Pacifica

Tuesday May 3 2016

Tina Wehrmeister
Planning Director
City of Pacifica
1800 Francisco Blvd
Pacifica, CA 94044

Dear Ms. Wehrmeister

RE: Pending Permit to destroy the Heritage Trees in front of the Casa Pacifica Apts.

This is a PS to the formal objection to the above I posted last Thursday with City Hall on behalf of several residents of Casa Pacifica Apts of which I am one.

Now that the Heritage Trees issue has come forth, I am noticing for the first time that Pacifica is literally saturated them and they all gracefully reenforce the historical charm of this small town.

Right across the street, for example, they also line the front of the Pacific Oaks Apartments. See pano pix assembly enclosed.

Note that the tall ones come near or in some spots even contact the power lines as they do in numerous other spots all over town without any apparent concern by PGE.

Several of the Pacific Oaks trees have also been "severely topped" just as some of those that line the front of the Casa Pacifica Apts. I am no arborhist but the short trees do not appear to have suffered any harm from it all. On the contrary, in my opinion, they all look to be in very vibrant, green health.

A few of the severely topped Pacific Oaks trees are closer to the sidewalk than ours and the one adjacent to the apartment sign overhangs their driveway. If a falling limb issue attributed to weak branch connections possibly caused by the severe topping is an issue, it would appear the hazard from such would be stronger for the Pacific Oak trees.

Sincerely

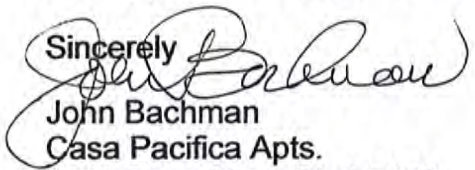

John Bachman
Casa Pacifica Apts.
1060 Terra Nova Blvd 209B
Pacifica, CA 94044
650-557-1507 tele and fax
JhnBachman@aol.com



PACIFIC CENTS APPTS
TERRA XIDUA / SPDS TAN
PACIFIC CENTS AT 94004

TOPPED HERE IN
TRES
CROSS SIDEWALK

5/3/16

PACIFIC OAKS APPTS
TERRACE NORTH / SODD STRIP
PACIFIC OAKS DRIVE

TOPPED HERITAGE TREES
OVERPARKING
DIRECTIONS
FALLING LIMBS
LAND IN THE
VEHICLE PARKING

REPLACES
OVERPARKING
THE DRIVE
WAY.



THE PINE ...

5 TOPPED HERITAGE TREES; 2 THAT WENT ...

AND 10 THE
VERTICAL PLANT



PACIFIC OAKS APPTS
TERRACE BLVD / GOODSTAD
PACIFIC OAK BLVD

TOPPED THESE TREES
NEAR SIDEWALK



POWER
LINES



... on
way



PARK MALL
TERRACE NORTH / OPPOSITE
PARK MALL @ 2400 W



PROXIMITY VACATION?

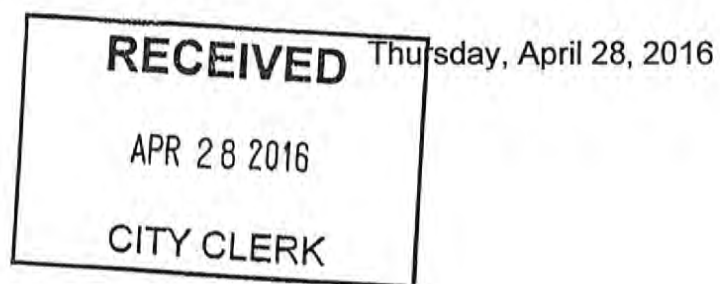

City Clerk or
Tina Wehrmeister
Planning Director
City of Pacifica
2800 Francisco Blvd.
Pacifica, CA 94044

Dear Ms Wehrmeister

RE: Heritage Tree Removal Permit - 1060 Terra Nova Blvd

I am writing to you on behalf of several tenants of the Casa Pacifica apartments about the removal our Heritage Trees. We have several objections and points

1. Unsustainable

May we respectfully point out that these 20 trees have easily sustained themselves without any help from anyone through the worst drought California has had in years. And they continue to do so.

About 10 have been topped but has anyone actually documented there is decay (the possibility of which you point out) which *could create* a "hazard" from "multiple leaders that grow from the wound sites that are generally weakly attached to the tree." ?

If you have hard evidence of such decay or "leaders" which are weakly attached to the tree": we would much appreciate reviewing it please.

Without such evidence it seems to us that a claim of "weak attachment to the tree" cannot be held as fact and is - *in fact* - speculation.

Otherwise, may we ask, what is the "hazard" this topping creates to which you refer?
Is it from falling limbs?

There must be hundreds of other trees in the City which require more than usual trimming over the years. Have their limbs too, become falling hazards ?

I have 3 of the shorter, topped trees right in front of my 2nd floor balcony and the pine needles are as vibrant and healthy as any other on the tree. I've been here over 15 years and their healthy condition has never deteriorated.

Our conclusion is that the Heritage Trees quite naturally adapted to their reduced height years ago and are now doing just fine in spite of it.

2. Power lines

Other power lines all over town run through the limbs of thousands of other trees here.
May we ask, are you calling for the removal of all such trees?

When the first notice to destroy the Heritage Trees was received several months ago, I submitted several color photos showing that the power lines were actually above or in front of 19 of the 20 trees. But - if power lines that run through the branches of numerous other trees all over town is allowable, we hold that the Heritage Trees should be granted the same allowance.

Has PGE complained about the location of their lines above or in front of the Heritage Trees? Or about the 1 tree their lines do run through? If yes, may we review a copy please?

3. Permit to destroy Heritage Trees is from the owner of Casa Pacifica

To the best of our knowledge, the request for a permit-to-remove the Heritage Trees did not come from PGE. It came from the owner of these apartments who has been in the

process of "beautifying" the place for the last year with -

- (a) Brand new redwood decks (complete)
- (b) A new exterior 3-color new paint job for both buildings (complete)
- (c) Brand new side-opening windows (complete)
- (d) A complete remodeling to come of the entrance area (to come)
- (e) Removal of the Heritage Trees (to come)

We believe the renovations are profit-driven toward the sale of Casa Pacifica at the maximum price possible in near future. We do not feel the protection and preservation of the Heritage Trees should be driven by profit considerations but by the 10 reasons listed in 5 below.

4. Proximity to the buildings

We divided Casa Pacifica length into 3 sections. See Landscapers drawing. We find:

West End - 8 trees from Aspen Drive to the Casa Pacifica Main Entrance

3 are about 8-9 feet from the building

1 is 6 feet from the building

4 are 10 feet or more away from the building .

Center Section - 8 trees from the Main Entrance to the Side Door Ramp

2 are about 8 feet from the building

1 is 4 feet from the building

1 is about 6 feet from the building

4 are 10 feet or more from the building

East End - 4 trees from the Side Door Ramp to the East End Parking lot.

All are 10 feet or more away from the building

Please advise what your definition of "proximity" is.

Or please advise which of the above trees is too close to the building. We found only 1 tree in the Center Section which be too close at about 4 feet from the building.

Also would you be so kind as to advise why "proximity" to the building is such a bad condition that the only possible relief for it is total destruction of all the trees?.

5. Pacifica Municipal Code, Chapter 12, Preservation of Heritage Trees

SEC 4-12.01 - Purpose

lists 10 reasons showing what the whole purpose of these codes are. It seems to us that an approval of this permit to destroy them violates every one of them.

For example, **(2) reads** - To protect and preserve the attractiveness, aesthetic and scenic beauty and historical atmosphere of the city.

As of today, Casa Pacifica is pleasingly framed by the green trees behind it and the Heritage Trees in front of it. Destruction of Heritage Trees will destroy the image and its historical aspect. See photo attached

Sec 4-12.05 Applications

(a) reads that the applicant shall include a statement of the reason for the requested destruction of the Heritage Trees. May we please have a copy of the applicant's (Steve Svienty) written reason for the destruction of the Heritage Trees when he doesn't even live here.

NOTE

Please also advise what Mr. Svienty's professional credentials are in handling

any part of the proposed destruction of the Heritage Trees. We could not find a listing for him as a California Licensed Contractor nor as a member of any local, regional, or national organization or association of Arborhists

6. Otherwise

- a. May we please have the chance to review a copy of Mr. Donald Cox's Arborist Report before any final decision is reached.? This will give us the chance to consider recruitment of our own professional arborhist
- b. The landscape architects drawing is inaccurate
The entrance to the office from the street is not at all shaped the way it is drawn
The line work behind the tree line is apparently drawn to indicate the shape of the building itself but the building is not that shape at all.
The positions of the trees does not match up consistently with photos of the trees themselves.
The East End Section of the landscaper's drawing shows 6 current Heritage Trees Inaccurate. There are only 4 in this section We get the impression the landscape architect has not taken a careful assessment of the situation
- c. The proposed Washington Thorn Trees grow to 25-35 feet high and wide but the landscaper's drawing shows them planted only 20 feet apart. As they grow their branches will become entangled with each other and will press up against the building and even the windows of each apt. Talk about proximity.
- d. The landscapers drawing also shows the new trees planted immediately adjacent to the sidewalk .Clarification please. This does not look accurate. If accurate, when the trees reach 30 feet in width their branches will be hanging into the traffic lanes and in need of constant trimming.
- e Why the need now for "deep root" barriers? The Heritage Trees roots were, to my knowledge never given such.and never caused any problem
- f. We count a total of 20 existing trees, not 19. Recounted on foot three times and confirmed. This again gives us the impression the landscaper did not take a careful assessment of the layout

Sincerely



John Bachman

Casa Pacifica

1060 Terra Nova Blvd 209B

Pacifica, CA 94044

650-557-1507 tele and fax

JhnBachman@aol.com

Attachments

Several color photos including one panorama of both buildings

Copy of thee landscapers drawing showing the 3 sections we devised

to count the trees

- 12.07. - Tree protection plans.
- 4-12.08. - Building permits.
- Sec. 4-12.09. - Notices of actions on permits and appeals.
- Sec. 4-12.10. - Permits: Fees.
- Sec. 4-12.11. - Violations: Penalties.

CHAPTER 12. - PRESERVATION OF HERITAGE TREES*



* Sections 4-12.01 through 4-12.11 , codified from Ordinance No. 333-C.S., as amended by Ordinance No. 386-C.S., effective February 8, 1984 and Ordinance No. 444-C.S., effective June 12, 1985, amended in their entirety by Ordinance No. 542-C.S., effective January 10, 1990)

*PACIFICA
MUNI
CODES*

Sec. 4-12.01. - Purpose.



- (a) It is recognized that the preservation of heritage trees on public and private property is important for the following reasons:
- (1) To encourage and assure the continuance of quality development;
 - (2) To protect and conserve the attractiveness, aesthetic and scenic beauty, and historic atmosphere of the City;
 - (3) To protect the environment and climatic balance of the City;
 - (4) To aid in the reduction of air pollution by protecting the known capacity of trees to produce oxygen and ingest carbon dioxide;
 - (5) To help reduce potential damage from wind by decreasing wind velocity;
 - (6) To provide shade;
 - (7) To act as a noise buffer; and
 - (8) To assist in the absorption of rainwater into the ground, thereby protecting against potential damages from soil erosion, mudslides and flooding, as well as reducing the cost of handling storm water by artificial means.
- (b) In order to promote the health, safety, and general welfare of the citizens of the City, while recognizing individual rights to develop, maintain, and enjoy private property, it is necessary to enact regulations preserving and protecting trees on private or City-owned property within the City.

*PASSING
PERMIT
VIOLATES
ALL OF
THESE!*

(§ 1, Ord. 542-C.S., eff. January 10, 1990)

Sec. 4-12.02. - Definitions.





PROPOSED
TREE



© ELeNZ

← WILL SPREAD OUT
OVER TERRA NOVA!

→ WILL PRESS UP
AGAINST APT WALLS!

Search...

1 Washington Hawthorn Trees

2 Flowering Landscape Trees

3 Pink Dogwood Trees: How to Grow Cornus Florida

4 Top 10 Landscape Trees

5 Fall Foliage of White, Mountain Ash Trees

About.com About Home Landscaping ... Flowering Trees

Washington Hawthorn Trees

Ads Plant Tree Trees Tree & Shrub Care Landscaping Trees Grow Fruit Trees Shade Trees Pruning Trees

INDICATION

PAZEO® Solution is a prescription medicine used to treat eye itching associated with eye allergies.



Washington hawthorn tree. Courtesy: Missouri Botanical Garden

By [David Beaulieu](#)

Updated March 17, 2016.

Plant Taxonomy of Washington Hawthorn Trees:

[Plant taxonomy](#) classifies Washington hawthorn trees as *Crataegus phaenopyrum*.

Plant Type:

[Washington hawthorn trees](#) are [deciduous](#) flowering trees.

INDICATION

PAZEO® Solution is a prescription medicine used to treat eye itching associated with eye allergies.

USDA Plant Hardiness Zones for Washington Hawthorn Trees:

The climate is most favorable for growing Washington hawthorn trees in USDA plant hardiness [zones 5-9](#).

Characteristics of Washington Hawthorn Trees:

Generally speaking, Washington hawthorn trees attain a height of 25'-35', with a spread of 25'-35'. They produce white blooms in clusters, in [late spring](#) to early summer. The flowers yield to red berries that persist throughout winter and are eaten by birds, such as [cedar waxwings](#). The bark of Washington hawthorn trees is attractive, and the branches bear thorns. Summer leaves are a shiny, dark green; fall foliage ranges from orange to red.

Sun and Soil Requirements:

Grow Washington hawthorn trees [in full sun](#), where the soil has good drainage. Once established, they are reasonably [drought-tolerant](#).

CONTINUE READING BELOW OUR VIDEO

Red Wine? No Problem. 5 Secret Stain-Busting Fixes



Sign Up for Our Free Newsletters

- ✓ About Today
- ✓ About Home
- ✓ Landscaping

Enter your email

SIGN UP

LANDSCAPING CATEGORIES

- Landscaping Pictures ›
- Landscape Design Ideas ›
- Shrubs (Flowering, Evergreen) ›
- Low-Growing Plants (Perennials, Vines, etc.) ›
- Lawn Care Tips ›
- Organic Weed Control ›
- Fences, Driveways, Walkways ›
- Decks and Garden Arbors ›
- Backyard Water Features ›
- Pest Control, Pet Control ›
- Yard Maintenance Tips ›
- Solutions for Problem Areas ›
- Ornamental Trees: Best Choices ›
- Landscaping Help for Beginners ›

Search...

▶ 0:00 / 2:25 🔊 🔍

- Stone Walls and Patios ▶
- Landscaping Pictures ▶
- DIY Landscaping Projects ▶
- Uses for Landscape Plants, Lawn Care Tips ▶
- Updated Articles and Resources ▶
- Expert Videos ▶

Uses in Landscape Design:

Washington hawthorn trees are attractive enough to be treated as [specimens](#), and their foliage is dense enough for them to be used *en masse* as [privacy screens](#). Some homeowners take advantage of the thorns of Washington hawthorn trees and prune them into security hedges.

Other Hawthorns:

Washington hawthorn trees are native to the Southeastern U.S. But they are not the only hawthorns. **Indian hawthorns** (*Rhaphiolepis indica*) are [broadleaf](#) evergreens that are cold hardy only to zone 7. Note that they're of an entirely different genus.

English hawthorns (*Crataegus laevigata*) are sacred to the fairies in formerly Celtic lands. They're part of the "fairy-tree triad" that also includes oak and ash. Legend has it that where all three of these trees grow together, one may see fairies.

The Name: "Hawthorne" Trees or "Hawthorn" Trees?:

You'll sometimes see the misspelling, "hawthorne" trees. You may even remember seeing the name, "Hawthorne" in a book, convincing you that it's the proper spelling. But if so, chances are that the book was about literature, not trees. For Nathaniel **Hawthorne** was a great American writer of the 19th century. But the tree name is spelled without the "e." It is composed of "haw" (name for the berry of [Crataegus laevigata](#)) and "thorn" (for its thorny branches).

More on Washington Hawthorn Trees:

Washington hawthorn trees bloom in late spring to early summer. For homeowners who grow some of the popular flowering specimens that bloom earlier in the spring (e.g., [flowering dogwoods](#)), late bloomers such as Washington hawthorn trees can help bridge the gap between the spring's display of blooms and autumn's foliage show. For while the blossoms of early bloomers are pleasant sights for eyes sore from winter's barrenness, they desert us too quickly! Thoughtful landscape planning demands a yard with [four-season interest](#).

Note that this specimen is among the many common landscaping [plants poisonous to dogs](#). But on a positive note, they are [deer-resistant](#).

Back to => [Bad-Smelling Flowers](#)

Related

- Flowering Landscape Trees
- Indian Hawthorn Proves That Drought Tolerant Plants Can Be Beautiful
- 10 Best Small Trees for Your Yard
- Think of Hawthorn Fruit as Teeny, Weeny, Mild Apples

More from the Web

Powered By Zerg



Wife of Eagles' Randy Meisner Shot and Killed

10 Worst Plants to Grow in Your Yard

Alyssa Milano Doesn't Look Like This Anymore

How to Fix a Peeling Leather Couch



About Home Follow us:

We deliver. Get the best of About Home in your inbox.

Enter your email

SIGN UP

Our Story

Advertise With Us

Site Map

Help

Write for About

Careers at About

Terms of Use & Policies

© 2016 About.com — All rights reserved.

Also from About.com: [Verywell](#)

SFGATE

How Dangerous Are the Thorns on a Hawthorn Tree?

by Barbara Ruben, Demand Media



A hawthorn tree's sharp thorns can lead to injuries and disease.

With their plentiful dagger-sharp thorns, it's not hard to understand how the hawthorn tree got its name. Depending on the variety of hawthorn, the thorns on the trees' branches, twigs and even trunks can be straight or curved. Some thorns can measure up to four inches long. Not only can the thorns cause puncture wounds, there have been cases in which they have been responsible for bacterial infections and allergic reactions.

Sponsored Link

Sutterfield Consignment

Shop high-end at affordable price. Designer furniture and home decor.

sutterfields.com

Hawthorns

In folklore, the story goes that Paul Bunyan used a hawthorn tree as a back scratcher. Some believe the crown of thorns worn by Christ was made from the hawthorn. There are numerous types of hawthorns. The black hawthorn, also called the Douglas hawthorn (*Crataegus douglasii*) has straight to slightly

curved 1-inch thorns, while the river hawthorn (*Crataegus rivularis*) has thorns that grow up to 1 1/2 inches. The Columbia Hawthorn's (*Crataegus columbiana*) thorns are even longer, measuring 2 to 4 inches.

Thorn Wound Dangers

With their sharpness and size, a hawthorn tree's thorns can cause serious wounds. When pruning, heavy gloves and goggles should be worn. There have been cases of eye scratches from the thorns that have led to blindness. Contact with thorns can also cause puncture wounds in the skin. If you are wounded by the thorns you should get a tetanus shot if you have not had one in the last 10 years.

Allergic Reactions

Not only can a scratch or puncture wound from a thorn cause pain, some people can be allergic to hawthorn thorns. Those who are allergic may have intense pain that lasts for several days and swelling around the injury. Antihistamines can help with allergic reactions, but if the injury does not improve within a few days, a doctor should be consulted.

Bacterial Infections

Plant pathogens on the thorn have also caused infections in those with hawthorn puncture wounds. In one case, a child developed septic arthritis due to the bacteria *Curtobacterium* after being punctured by a coxspur hawthorn thorn. Another child was infected with the bacteria *Pantoea agglomerans* and *Enterobacter cloacae* after injury from a thorn that lodged under her skin.

Sponsored Links

Quotes on Tree Service

Find Local Tree Services Now.

Fast & Free. Enter Your Zip Code!

tree-service.homeadvisor.com

Emergency Tree Removal

Fully Insured Quality Tree Care

Get a Free Estimate. Call Now!

www.naturalarborcare.com

1 Tip of a flat belly :

Cut down a bit of your belly every day by using this 1 weird old tip.

superfatburningfats.com

Search...

INDICATION
 PAZEO® Solution is a prescription medicine used to treat eye itching associated with eye allergies.

About.com About Home Landscaping ... Glossary for Words Used in Landscaping

Maps for Growing Zones From the USDA

By David Beaulieu
Landscaping Expert

SHARE

Ads [Planting](#) [Landscape](#) [Gardening](#) [Landscaping](#) [Zone 9 Gardening](#) [USDA](#) [Gardening and Landscaping](#) [How to Landscape](#) [Plant](#) [Grow](#)

1 of 6 Map for Growing Zones for the Northeastern U.S.

Use to navigate.



USDA growing zone map for the North East U.S. Photo Credit: USDA

Updated January 29, 2016.

Growing zones (also called "planting zones") are intended to be taken as advise, not gospel. There are so many [microclimates](#) (both natural and manufactured ones) that you really cannot say definitively that a plant of borderline hardiness in your area will or will not grow for you until you have tested it.

For purposes of the USDA [planting zones](#), the meaning of "Northeastern" is somewhat expanded beyond how it is used in everyday speech.

Ads
1 Tip of a flat belly :
[superfatburningfats.com](#)
 Cut down a bit of your belly every day by using this 1 weird old tip.

- [Planting](#)
- [Landscape](#)
- [Gardening](#)
- [Landscaping](#)
- [Zone 9 Gardening](#)

It does not consist simply of the New England states and New York. Rather, it extends south to Virginia and West to Michigan.

Massachusetts, alone – a relatively small state, in terms of territory (and occupying an especially narrow band of land North to South) – contains five different growing zones (3-7). The northern reaches of Michigan, New York, Vermont, New Hampshire and Maine include some of the coldest patches in the continental U.S.

Browse through the growing-zone maps on the following pages until you find the one that represents your own U.S. region.

Sign Up for Our Free Newsletters

- ✓ About Today
- ✓ About Home
- ✓ Landscaping

Enter your email

SIGN UP

LANDSCAPING CATEGORIES

- Landscaping Pictures ›
- Landscape Design Ideas ›
- Shrubs (Flowering, Evergreen) ›
- Low-Growing Plants (Perennials, Vines, etc.) ›
- Lawn Care Tips ›
- Organic Weed Control ›
- Fences, Driveways, Walkways ›
- Decks and Garden Arbors ›
- Backyard Water Features ›
- Pest Control, Pet Control ›
- Yard Maintenance Tips ›
- Solutions for Problem Areas ›
- Ornamental Trees: Best Choices ›
- Landscaping Help for Beginners ›
- Stone Walls and Patios ›
- Landscaping Pictures ›
- DIY Landscaping Projects ›
- Uses for Landscape Plants, Lawn Care Tips ›
- Updated Articles and Resources ›
- Expert Videos ›

INDICATION

PAZEO® Solution is a prescription treat eye itching associated with e

TODAY'S TOP 5 PIC



15 F
Flor
By F
Papi



4
Hov
Ref
Dec
By E
Horr



3
Hov
Dec



2
Org
Pro
30 f
By E
Pers
Expr



1
365
Eve
Yea

VIEW MORE IN

HOME

1 of 6 -



Show All

Related Articles

- [Plan Your Garden With This Climate Zone Guide](#)
- [What Is Your USDA Plant Hardiness Zone?](#)
- [Knowing Your Plant Hardiness Zone is Key - Here's How to Find It.](#)
- [Learning More About Hardiness Zones](#)
- [Find Your USDA Zone](#)
- [World Hardiness Zones](#)

Our Expert Recommends

- [Elephant Ears](#)
- [Gerbera Daisy](#)
- [Bird of Paradise](#)
- [Aloe Vera Plants](#)
- [Mexican Bird of Paradise](#)
- [Lantana Plants](#)
- [Deer-Resistant Ornamental Grasses](#)
- [Deer-Resistant Perennials](#)
- [Deer-Resistant Bulbs](#)



Wh
Use
Dec
Spa



Tip:
Bar
Spa



Bef
Hot
Mar

VIEW MOR

Landscaping Essentials



Don't Know Much About Landscaping? Start Here!
Landscaping Help for Beginners



Looking for Info on a Specific Plant? Browse My Database
Plant Database



10 Ways to Make Your Yard Look Like Hell (and How to Avoid It)
Landscape Design Ideas



Landscapes Can Be Low-Maintenance, but They Are Never No-Maintenance
Yard Maintenance Tips



Pictures Illustrating the Concepts Used by Landscaping Pros
Landscape Design Ideas

Home Slideshows



365 DIY Projects for Every Day of the Year

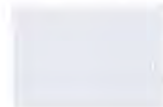

House Tour: See Inside This Beautiful Beverly Hills Home
Interior Decorating



How to Decorate Every Room in Your House



How to Find Your Decorating Style



Your A-to-Z Guide to Spring Cleaning

Readers Recommend

- **10 Ways to Keep Cats Out of Your Yard**
- **How to Build Great Rock Gardens for Small Spaces**
- **Pictures of Poison Ivy**
- **Poison Sumac Pictures**
- **10 Shrubs That Thrive in the Shade**

[Ads](#)
[Planting](#)
[Landscape](#)
[Gardening](#)
[Landscaping](#)
[Zone 9 Gardening](#)
[USDA](#)
[Gardening and Landscaping](#)
[How to Landscape](#)
[Plant](#)
[Grow](#)

[About.com](#)
[About Home](#)
[Landscaping](#)
[Landscaping Help for Beginners](#)
[Glossary for Words Used in Landscaping](#)
[Maps for Growing Zones From the USDA](#)

[About Home](#) Follow us:

We deliver. Get the best of About Home in your inbox.

Enter your email

SIGN UP

[Our Story](#)
[Advertise With Us](#)
[Site Map](#)
[Help](#)

[Write for About](#)
[Careers at About](#)
[Terms of Use & Policies](#)

© 2016 About.com — All rights reserved.

Also from About.com: [Verywell](#)

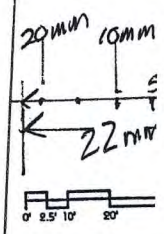
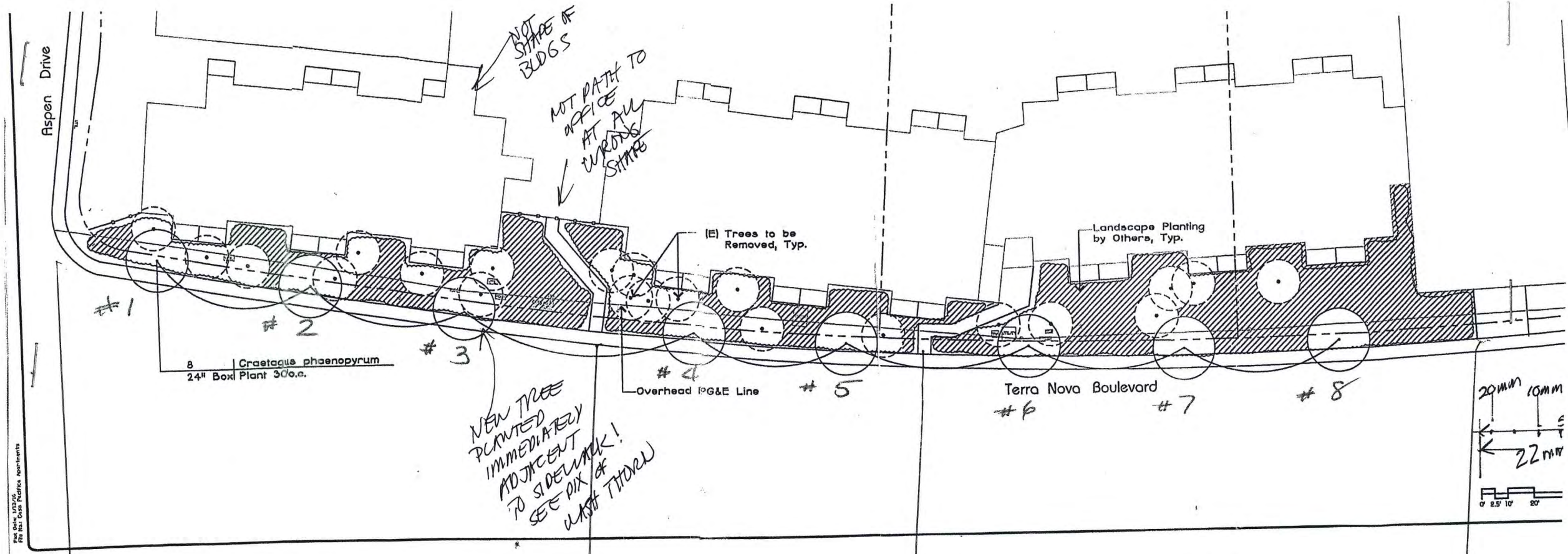

WEST END
8 EXISTING TREES

CENTRAL
SECT
8 EXISTING TREES

EAST
END
4 EXISTING TREES
(NOT SIX AS
SHOWN)
INACCURATE!

To Bachman
7/27/15

41

WEST
END

MAIN
ENT

CENTRAL





FEET BUD
NOUN BUD

POLE

RAMPING
PAVING

TWO
"SEVERLY
TOPPED"
ONE

EAST END

FRM
FROM
WALL

UPPER
PRIME
EAST END
PARTIUS

EAST END

EAST END

EAST END
PARKING
LOT

4/28/16



The green trees behind the Casa Pacifica together with the green Heritage Trees in front frame the buildings in green - aesthetically pleasing. Helps boost property values and attract new business





1.1.2006 01:00



April 26th, 2016

Public Works Superintendent

City of Pacifica, CA

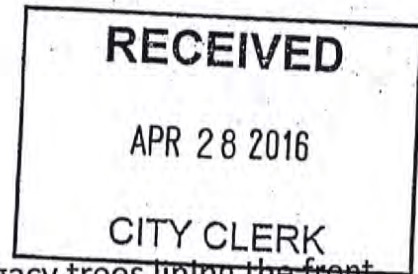

Dear Superintendent,

I am responding to the yellow notice to remove old legacy trees lining the front sidewalk of 1060 Terra Nova Blvd at Casa Pacifica Senior Retirement housing, across from library.

I am 85 years old paraplegic living in apt. 109D, ground floor. I have lived here for over 15 years, and plan to stay here for the rest of my life. Every morning, I look out of my bedroom window and start my day with looking at the green tree leaves and hear the birds sing. It is my connection to nature and peaceful living.

After a recent surgery, I am staying in bed for 15 plus hours a day most days, because I cannot get out of bed into wheelchair without assistance.

These trees help me go through my day when I am suffering from pain or lonely.

I consider the tree outside my patio my constant companion. It gives me shade, fresh air and a good mood.

Please reconsider not cutting down all these beautiful and strong legacy trees.

I believe they will do more good than harm to the residents of Pacifica in the long run. It speaks of history and steadfastness in surviving all these years.

Thank you for considering my plea.

Sincerely,

Saw Kam Woo

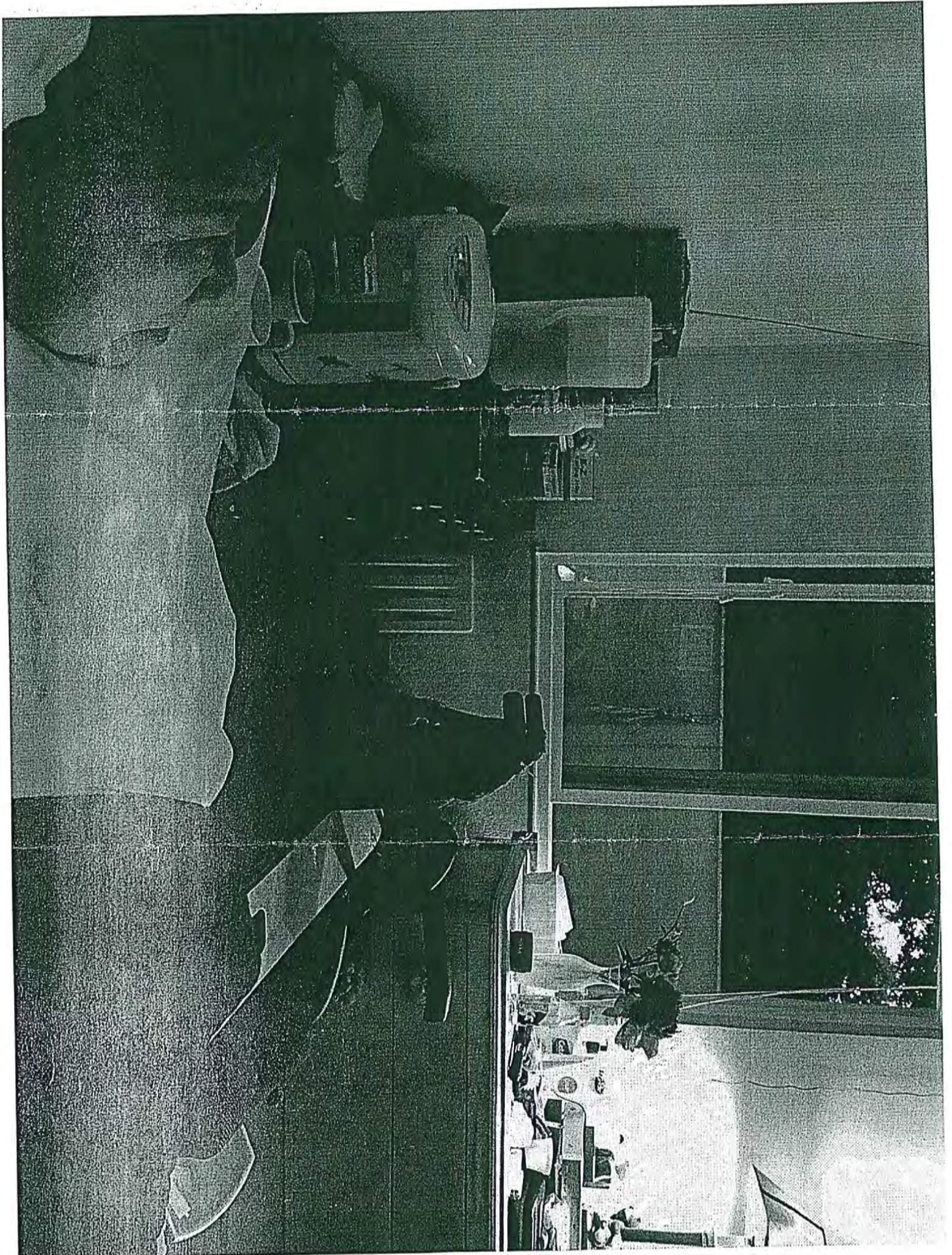

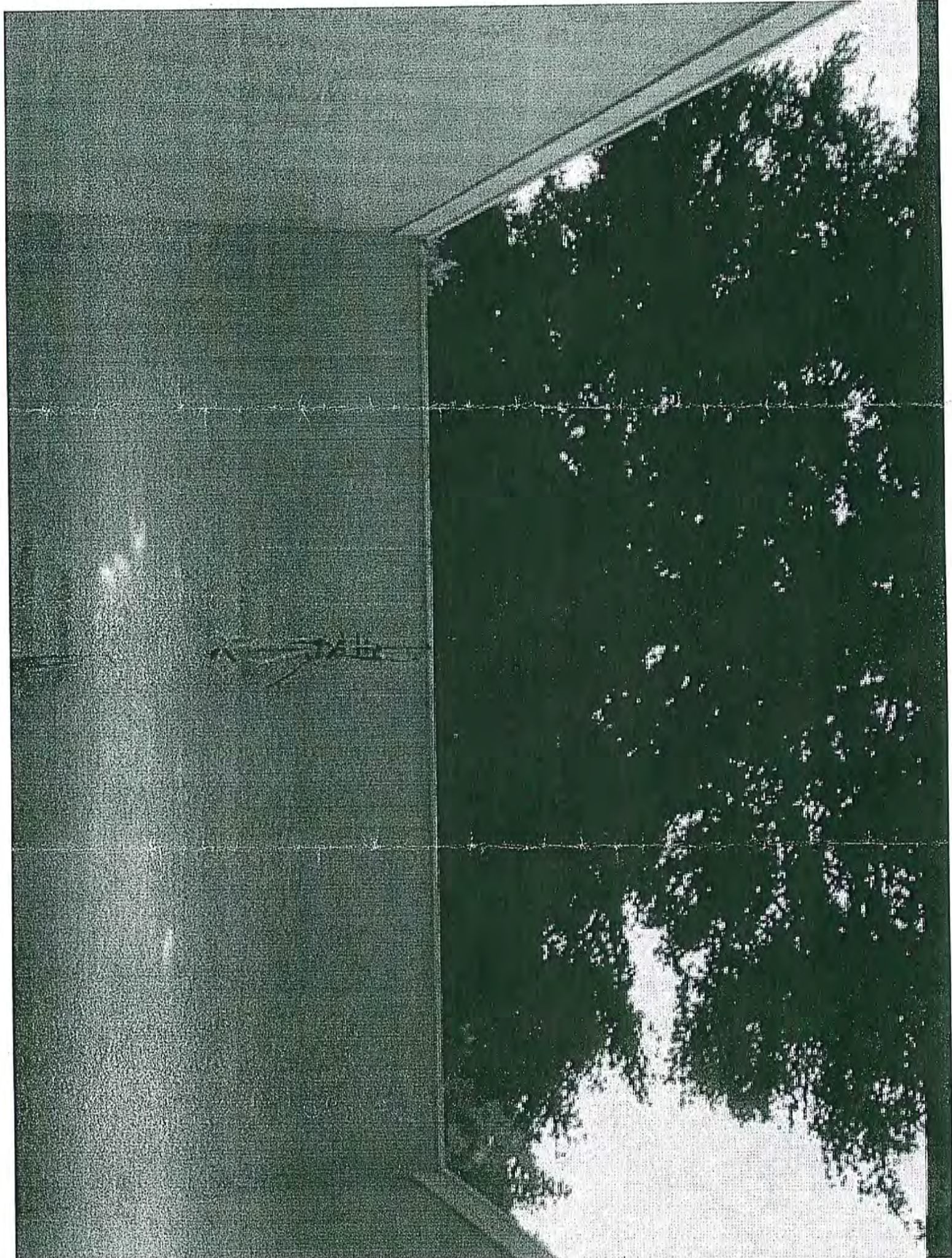

RECEIVED

APR 27 2016

CITY CLERK

April 26, 2016

To: City of Pacifica
City Clerk - Tree Appeal

I respectfully appeal/oppose the ^{removal of} numerous
Heritage trees located on the far east end of
Terra Nova Blvd. in front of the senior homes.

Not only are these trees crucial to the aesthetic
of the area, they are crucial in the world's battle
against climate change. Trees serve multiple purposes
and these two far out weigh a few lifted side-
walks and cement patios.

These trees add value to the area and the two native
coastal cypress are simply beautiful and not too
many remain in the area anymore relative to a couple of
decades ago. Tree removal (especially thriving trees) is
not right, planting trees is the correct direction.

I propose that if these trees are in fact removed, then the same amount of trees must be planted furnished by whomever is paying to remove them. If I wanted to live in an area that consisted of rows of homes and businesses without any trees around, I would move to Daly City. Trees and greenery is what makes cities beautiful and these trees are just that.

Sincerely,

Jacqueline Godsoe
Pacifica Resident (Lifetime)

650-255-6840

April 25, 2016

1060 Terra Nova Blvd. Apt. 202-B
Pacifica, CA 94044

City of Pacifica
City Clerk - Tree Appeal
170 Santa Maria Avenue
Pacifica CA 94044

Dear Sirs;

I am writing to convey my concern about your decision to allow the removal of trees in front of my residence at Casa Pacifica Apartments, 1060 Terra Nova Blvd.,

I strongly object to this decision for a number of reasons:

1. The trees represent an important amount of greenspace in a densely populated neighborhood.
2. They provide an important noise barrier to a heavily travelled street and shopping center across the street.
3. They are an important source of oxygen as they displace CO2 in the air.
4. They are important as habitat for birds and small animals whose presence is enjoyed by the residents.
5. They are part of the heritage of this neighborhood and a key component of its aesthetic appeal.
6. The age and character of many of these trees is not something to be dismissed or eliminated thoughtlessly.

I urge you to reconsider the survival of these pillars of our community.

Sincerely,

Jack Coote
jawacoots@gmail.com





Scenic Pacifica
Incorporated Nov. 22, 1957

CITY OF PACIFICA
Planning, Building, and Code Enforcement
1800 Francisco Blvd. • Pacifica, California 94044-2506
(650) 738-7341 • www.cityofpacifica.org

MAYOR
Karen Ervin

MAYOR PRO TEM
Sue Digre

COUNCIL
Mary Ann Nihart
Mike O'Neill
John Keener

October 30, 2015

Steve Svienty
867 47th Ave., Apt. #A
San Francisco, CA 94121

Subj: Heritage Tree Removal Permit – 1060 Terra Nova Blvd.

Dear Mr. Svienty:

The City of Pacifica is in receipt of your request to remove 19 trees at the address listed above regulated under the City's Preservation of Heritage Trees ordinance.

In accordance with the provisions of Pacifica Municipal Code Title 4, Article 12, the City has the ability to mitigate adverse effects of the requested tree removal. Although the existing trees are unsustainable due to size and impacts of previous pruning, the removal of 19 street trees will nonetheless have an adverse effect on the immediate area. Most obviously, aesthetics will be changed and there are also potential effects on shade and privacy of the adjacent apartment units.

I note that you have provided a bid for landscape replacement however, this document describes work to be completed in various areas of the entire site and it is difficult to determine what is proposed for the tree removal site without a corresponding landscape plan. Please provide a detailed landscape plan for the tree removal area. Please also consider mitigation of tree removal by proposing appropriate replacement street trees, large decorative shrubs, or other mitigating landscape treatment.

Direct any questions related to this permit to the Planning Department at (650) 738-7341.

Sincerely,

Tina Wehrmeister
Planning Director

cc: Department of Public Works

A Tree.

RECEIVED

AUG 26 2015

CITY CLERK

If you destroy the life, the leaves you see. You destroy the hope that lives beneath.

The air that flows. The life that grows.

If you cut her down in the prime of life, you can never get back all that's lost. You can never understand all that you've cost.

She shelters. She feeds. She dreams. She holds her memories deep in her core.

The laughter of those sunny days. She shields you from the mid days haze. Keeps you dry in the rain. Protecting you from the storm, from the pain.

So I say this to you in all sincerity. If you destroy that tree. You destroy me.

A Family